

HIGHWAY APPROACH SECTION

STA. 37+10.00 TO STA. 38+12.50
STA. 38+77.50 TO STA. 39+30.00

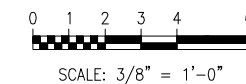
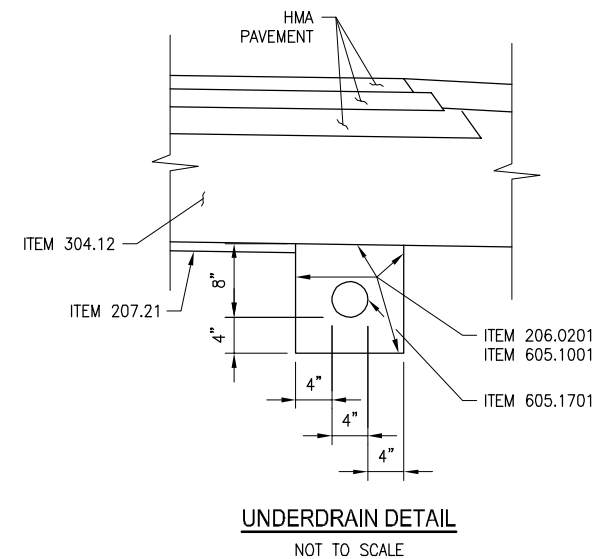
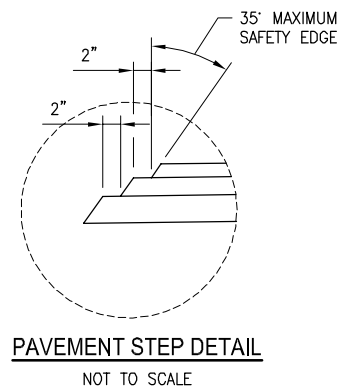

ITEM NO.	DESCRIPTION	UNIT	ITEM NO.	DESCRIPTION	UNIT	NOTES
203.02	UNCLASSIFIED EXCAVATION AND DISPOSAL	CY	605.1001	UNDERDRAIN FILTER, TYPE I	CY	1. ASPHALT PAVEMENT JOINT ADHESIVE (ITEM 418.7603) SHALL BE USED ON ALL VERTICAL FACES FOR ALL THE JOINTS ON THE TOP HMA PAVEMENT COURSE SUCH AS LONGITUDINAL, TRANSVERSE, CURBS OR OTHER JOINTS BUTTING AGAINST THE NEW HMA PAVEMENT.
203.03	EMBANKMENT IN PLACE	CY	605.1701	OPTIONAL UNDERDRAIN PIPE, 4" DIAMETER	FT	
206.0201	TRENCH AND CULVERT EXCAVATION	CY	606.10	BOX BEAM GUIDE RAILING	FT	
207.21	GEOTEXTILE SEPARATION	SY	608.020102	HOT MIX ASPHALT (HMA) SIDEWALKS, DRIVEWAYS, BICYCLE PATHS, AND VEGETATION CONTROL STRIPS	TON	
304.12	SUBBASE COURSE, TYPE 2	CY	610.1401	TOPSOIL, REUSE ON-SITE MATERIALS	CY	
402.098303	9.5 F3 TOP COURSE HMA, 80 SERIES COMPACTION	TON	610.1402	TOPSOIL, ROADSIDE	CY	
402.198903	19 F9 BINDER COURSE HMA, 80 SERIES COMPACTION	TON	610.1601	TURF ESTABLISHMENT, ROADSIDE	SY	
402.378903	37.5 F9 BASE COURSE HMA, 80 SERIES COMPACTION	TON				
407.0102	DILUTED TACK COAT	GAL				
418.7603	ASPHALT PAVEMENT JOINT ADHESIVE	FT				

DATE	REVISIONS	BY

DRAWING ALTERATION
Note: It is a violation of law for any person, unless they are acting under the direction of a licensed professional engineer, architect, landscape architect or land surveyor to alter an item in any way. If an item bearing the stamp of a licensed professional is altered, the altering engineer, architect, landscape architect or land surveyor shall stamp the document and include the notation "altered by" followed by their signature, the date of such alteration, and a specific description of the alteration.

BY: _____
DATE: _____

Lu Engineers
ENVIRONMENTAL • TRANSPORTATION • CIVIL
339 East Avenue, Suite 200
Rochester New York 14604
(585) 385-7417
Fax: (585) 546-1634
luengineers.com

PROJECT:
COUNTY ROAD 189 OVER GRUNLEY CREEK
B.I.N. 1039430 P.I.N. 7753.88 D0XXXXX

CLIENT:
JEFFERSON COUNTY HIGHWAY DEPARTMENT
21897 County Route
Watertown, New York 13601

DRAWING TITLE:
TYPICAL SECTIONS

DESIGNED BY: JRM SCALE: AS SHOWN
DRAWN BY: JRM DATE: DEC. 2019
CHECKED BY: KDW PROJECT No. 36205

SHEET 1 OF 3 DRAWING No. TS - 1

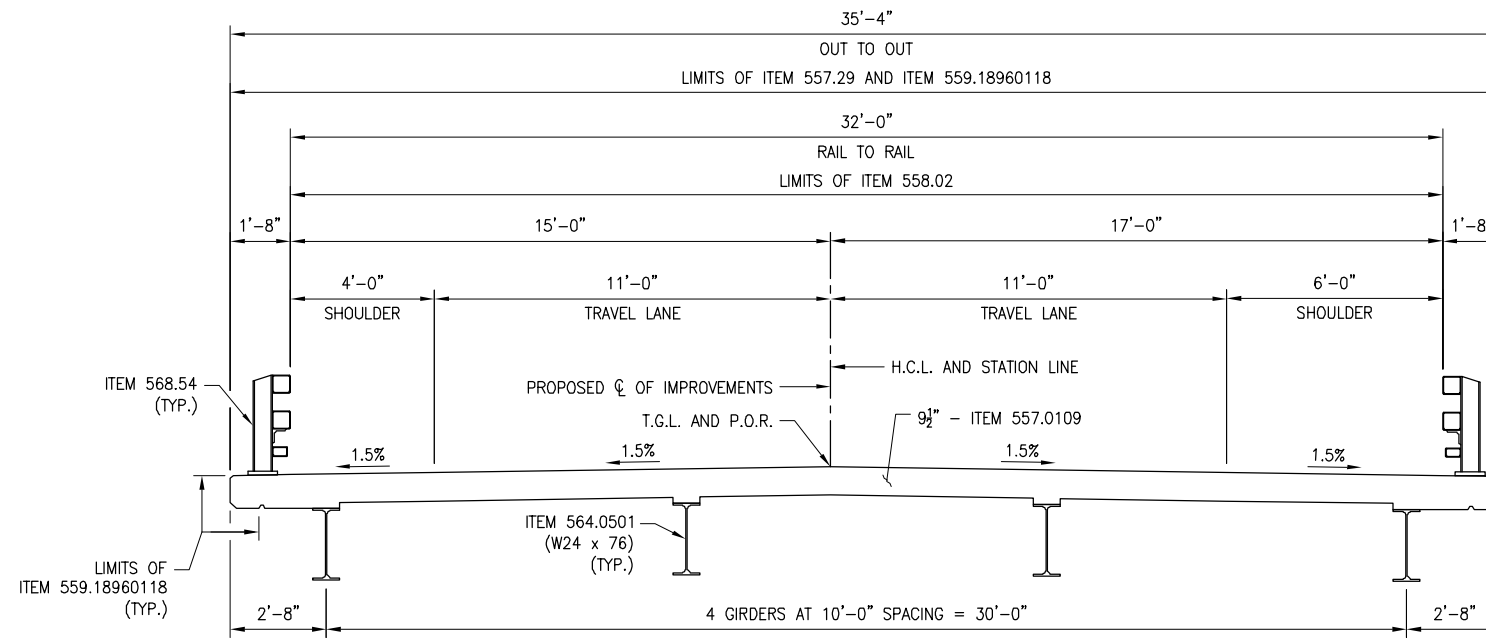

STEEL GIRDER BRIDGE SECTION
 STA. 38+27.50 TO STA. 38+62.50

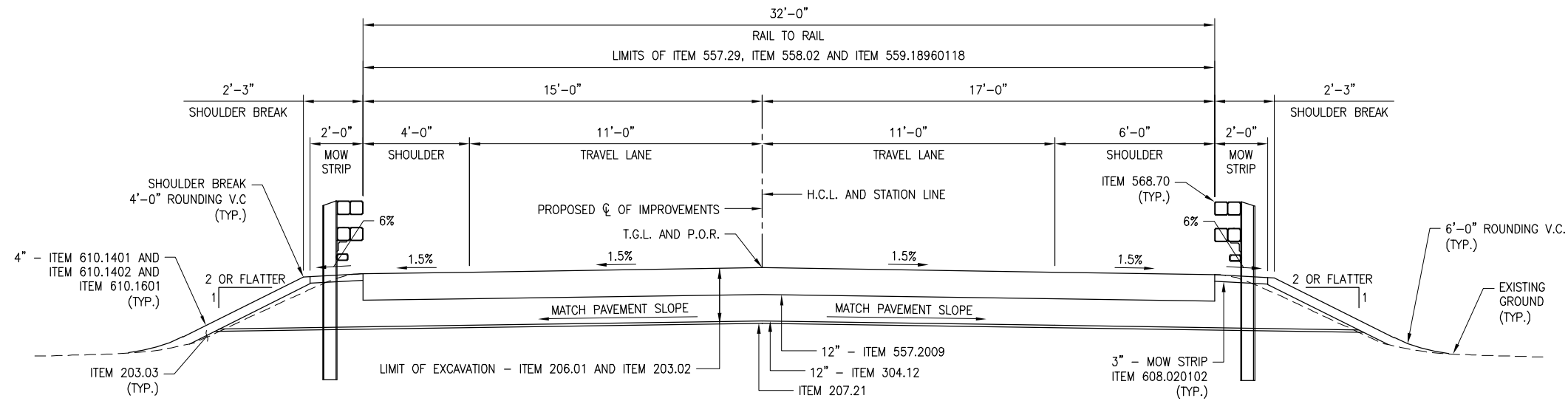

BRIDGE APPROACH SECTION
 STA. 38+12.50 TO STA. 38+27.50
 STA. 38+62.50 TO STA. 38+77.50

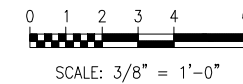

ITEM NO.	DESCRIPTION	UNIT	ITEM NO.	DESCRIPTION	UNIT	NOTES
203.02	UNCLASSIFIED EXCAVATION AND DISPOSAL	CY	564.0501	STRUCTURAL STEEL TYPE 1	LS	
203.03	EMBANKMENT IN PLACE	CY	568.54	STEEL BRIDGE RAILING, THREE RAIL	FT	
206.01	STRUCTURE EXCAVATION	CY	568.70	TRANSITION BRIDGE RAILING	FT	
207.21	GEOTEXTILE SEPARATION	SY	608.020102	HOT MIX ASPHALT (HMA) SIDEWALKS, DRIVEWAYS, BICYCLE PATHS, AND VEGETATION CONTROL STRIPS	TON	
304.12	SUBBASE COURSE, TYPE 2	CY	610.1401	TOPSOIL, REUSE ON-SITE MATERIAL	CY	
557.0109	SUPERSTRUCTURE SLAB WITH INTEGRAL WEARING SURFACE, BOTTOM FORM WORK REQ., TYPE 9 FRICTION	SY	610.1402	TOPSOIL, ROADSIDE	CY	
557.2009	STRUCTURAL APPROACH SLAB WITH INTEGRAL WEARING SURFACE, TYPE 9 FRICTION	SY	610.1601	TURF ESTABLISHMENT, ROADSIDE	SY	
557.29	WINTER SURFACE TREATMENT, SUPERSTRUCTURE SLABS AND STRUCTURAL APPROACH SLABS	SY				
558.02	LONGITUDINAL SAWCUT GROOVING OF STRUCTURAL SLAB SURFACE	SY				
559.18960118	PROTECTIVE SEALING OF STRUCTURAL CONCRETE ON NEW BRIDGE DECKS AND BRIDGE DECK OVERLAYS	SF				

DATE	REVISIONS	BY

DRAWING ALTERATION
 Note: It is a violation of law for any person, unless they are acting under the direction of a licensed professional engineer, architect, landscape architect or land surveyor to alter an item in any way. If an item bearing the stamp of a licensed professional is altered, the altering engineer, architect, landscape architect or land surveyor shall stamp the document and include the notation "altered by" followed by their signature, the date of such alteration, and a specific description of the alteration.

BY: _____
 DATE: _____



339 East Avenue, Suite 200
 Rochester New York 14604
 (585) 385-7417
 Fax: (585) 546-1634
 luengineers.com

PROJECT:
COUNTY ROAD 189 OVER GRUNLEY CREEK
 B.I.N. 1039430 P.I.N. 7753.88 D0XXXXX

CLIENT:
JEFFERSON COUNTY HIGHWAY DEPARTMENT
 21897 County Route Watertown, New York 13601

DRAWING TITLE:
TYPICAL SECTIONS

DESIGNED BY: JRM SCALE: AS SHOWN
 DRAWN BY: JRM DATE: DEC. 2019
 CHECKED BY: KDW PROJECT No. 36205

SHEET 2 OF 3 DRAWING No. TS-2

J:\Projects\36200 Jefferson County\36205 County Route 189 over Grunley Creek\36205 Preliminary Design\Cadd\Typical Sections.dwg, 12/22/19 3:35:07 PM, JMessinger



DATE	REVISIONS	BY

DRAWING ALTERATION
 Note: It is a violation of law for any person, unless they are acting under the direction of a licensed professional engineer, architect, landscape architect or land surveyor to alter an item in any way, if an item bearing the stamp of a licensed professional is altered, the altering engineer, architect, landscape architect or land surveyor shall stamp the document and include the notation "altered by" followed by their signature, the date of such alteration, and a specific description of the alteration.

BY: _____
 DATE: _____



339 East Avenue, Suite 200
 Rochester New York 14604
 (585) 385-7417
 Fax: (585) 546-1634
 luengineers.com

PROJECT:
**COUNTY ROAD 189
 OVER
 GRUNLEY CREEK**
 B.I.N. 1039430 P.I.N. 7753.88
 D0XXXXX

CLIENT:
**JEFFERSON COUNTY
 HIGHWAY DEPARTMENT**
 21897 County Route
 Watertown, New York 13601

DRAWING TITLE:
**ROADWAY
 PLAN
 AND
 PROFILE**

DESIGNED BY: JRM	SCALE: AS SHOWN
DRAWN BY: JRM	DATE: DEC. 2019
CHECKED BY: KDW	PROJECT No. 36205
SHEET 3 OF 3	DRAWING No. PL - 1

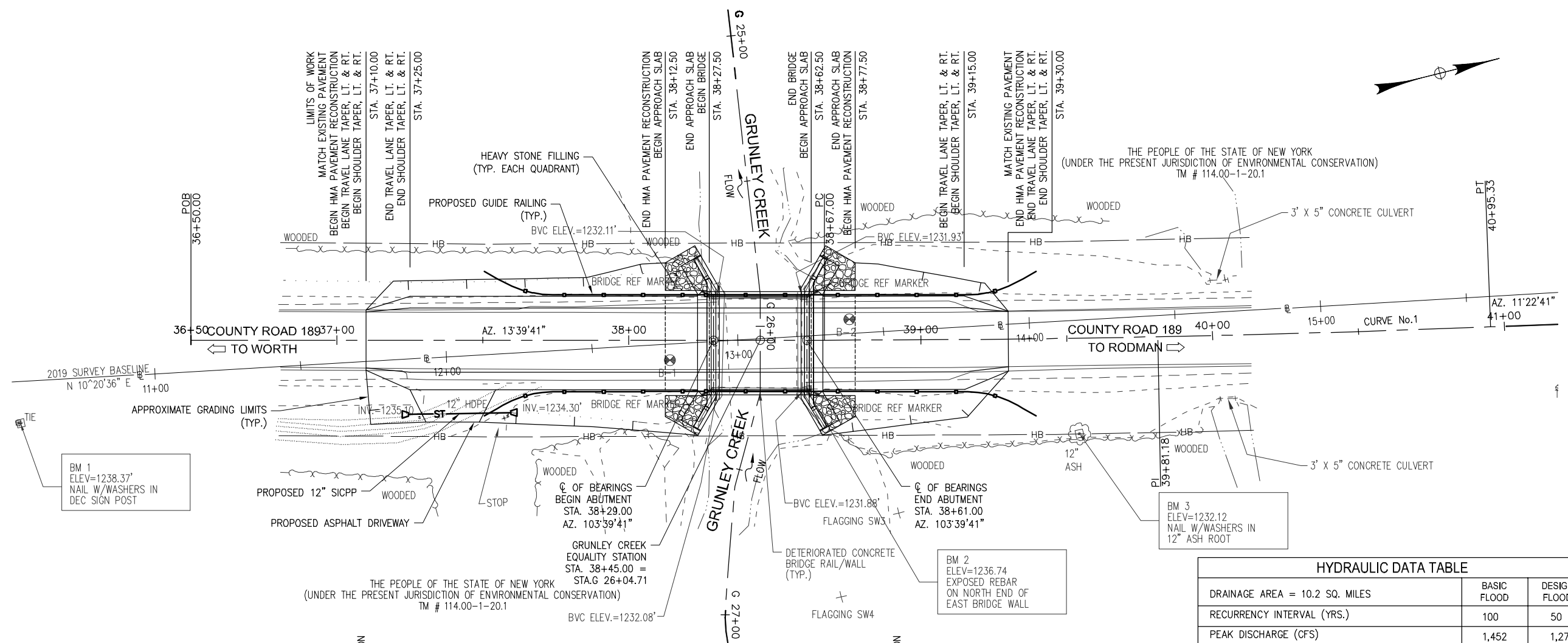

	BASIC FLOOD	DESIGN FLOOD
DRAINAGE AREA = 10.2 SQ. MILES	100	50
RECURRENCE INTERVAL (YRS.)	1,452	1,274
PEAK DISCHARGE (CFS)	1,230.24 FT	1,229.97 FT
HIGH WATER ELEVATION @ PT. OF MAX. BACKWATER	EXISTING 1,230.24 FT PROPOSED 1,230.24 FT	1,229.97 FT
AVE. VELOCITY THRU STRUCTURE @ DESIGN FLOOD = 7.3 ft/s		

POINT	STATION	NORTHING	EASTING
POB	36+50.00	1386299.55	1007606.99
PC	38+67.00	1386510.41	1007658.24
TANGENT DIRECTION		13° 39' 41"	
TANGENT LENGTH		217.00 FT	
CURVE No. 1			
PC	38+67.00	1386510.41	1007658.24
PI	39+81.18	1386621.36	1007685.21
CC		1387863.65	1002090.74
PT	40+95.33	1386733.30	1007707.73
DELTA	2°17'00.0" Left	EXTERNAL	1.14 FT
RADIUS	5,729.6 FT	LENGTH	228.33 FT
DEGREE	1°00'00.0"	TANGENT	114.18 FT
AHEAD TANGENT DIRECTION		13° 39' 41"	
BACK TANGENT DIRECTION		11° 22' 41"	
PT	40+95.33	1386733.30	1007707.73
POE	41+50.00	1386786.89	1007718.52
TANGENT DIRECTION		11° 22' 41"	
TANGENT LENGTH		54.67 FT	

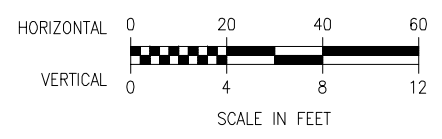
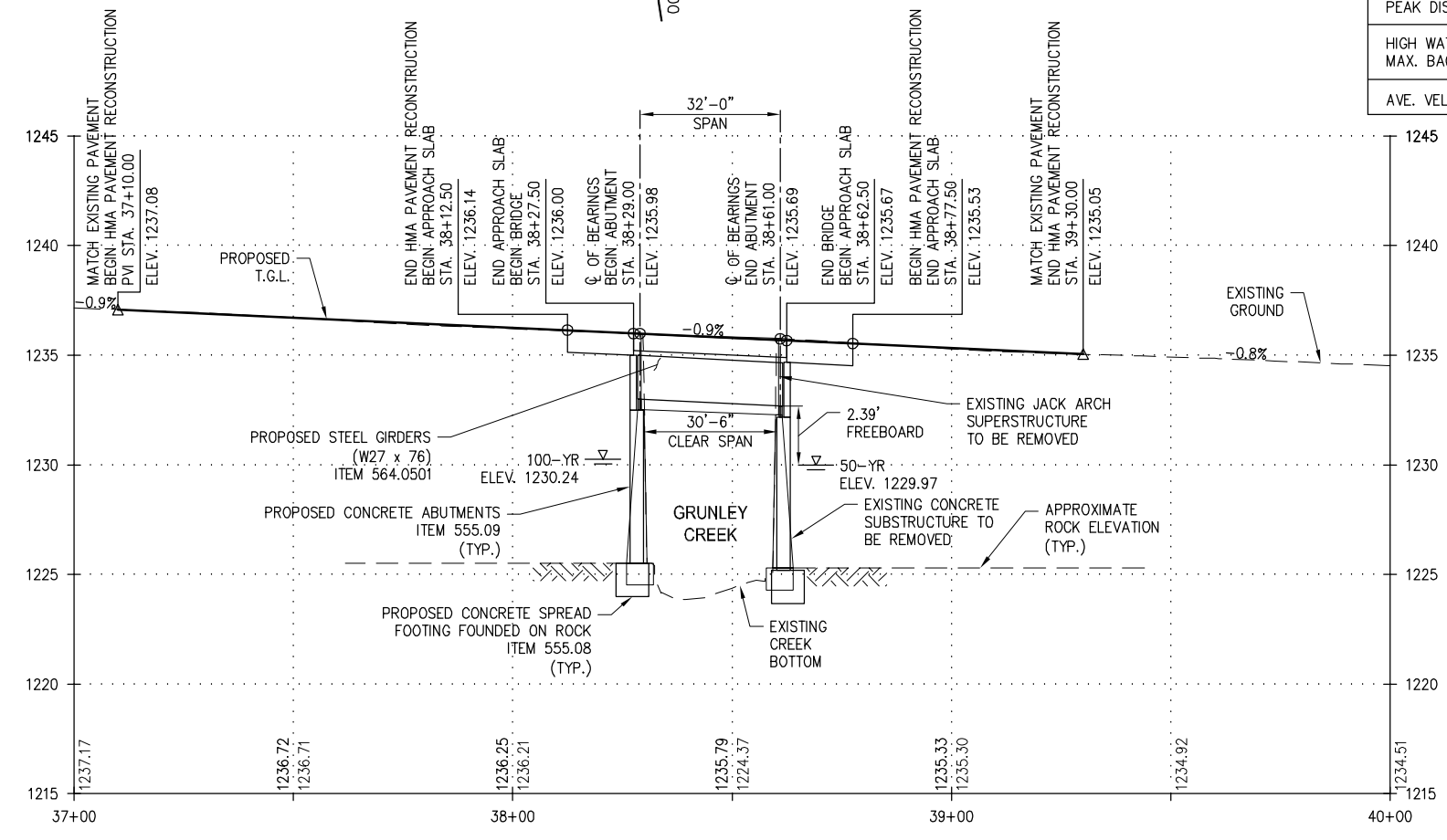

J:\Projects\36200 Jefferson County\36205 County Route 189 over Grunley Creek\Cadd\Preliminary Design\Cadd\Preliminary Drawings\Roadway\Plan and Profile.dwg, 12/20/19 3:41:55 PM, JMessinger